

**PROPOSED AND EXISTING
SITE PLAN AND USE MAP
304 TODD ROAD**

APN 134-171-050
SANTA ROSA, CALIFORNIA

JANUARY 2018



CIVIL ENGINEERS • URBAN PLANNERS • LAND SURVEYORS • LANDSCAPE ARCHITECTS
15 THIRD STREET, SANTA ROSA, CA 95401
TEL (707) 542-6451 FAX (707) 542-5212

PROPERTY OWNER:
GHILOTTI CONSTRUCTION
246 GHILOTTI AVE
SANTA ROSA, CA 95407
PHONE: (707) 595-1221

TOPOGRAPHIC MAPPING NOTE:
AERIAL MAPPING PERFORMED BY
VERTICAL MAPPING RESOURCES
ON MAY 27, 2016.
GROUND CONTROL PROVIDED BY
CARLILE MACY.
CONTOUR INTERVAL = 2'

BENCHMARK NOTE:
CITY OF SANTA ROSA-BM#D230
ELEVATION: 99.06
TODD RD. AND STANDISH AVE.; PK NAIL ON
CURB AT N/S CATCH BASIN IN NW CORNER,
AT NORTH END OF CURB RETURN.

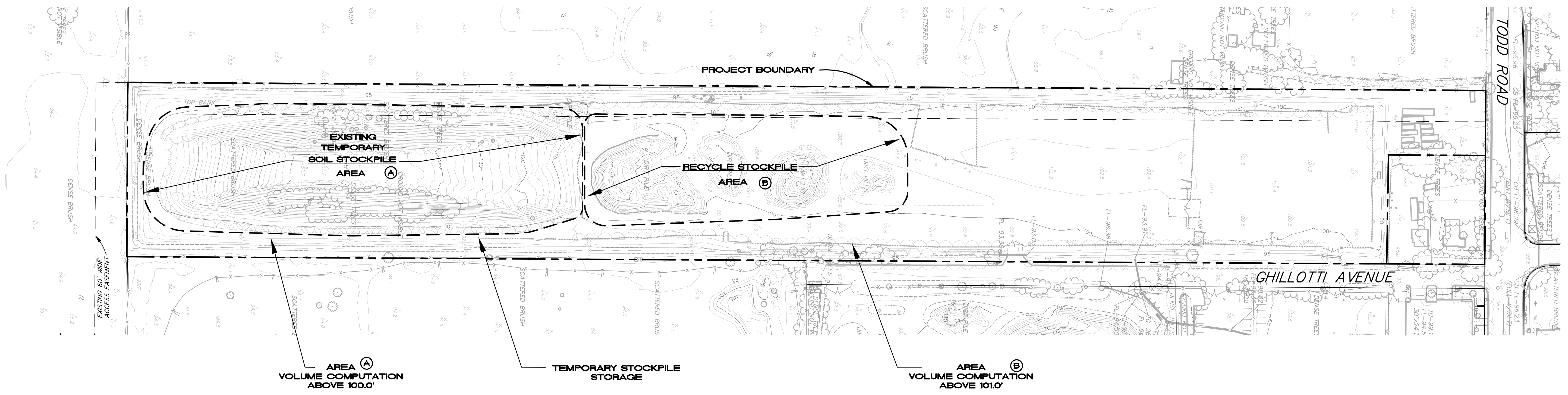

AREA A
VOLUME COMPUTATION
ABOVE 100.0'

TEMPORARY STOCKPILE
STORAGE

AREA B
VOLUME COMPUTATION
ABOVE 101.0'

**EXISTING
TEMPORARY STOCKPILE
QUANTITIES**

AREA SF	FILL CY
A	135,000
B	15,000
TOTAL	150,000

NOTE:
A + B = TOTAL VOLUME OF
EXISTING TEMPORARY
STOCKPILE MATERIAL PLACED
ABOVE PERMANENT FILL PAD
AS OF OCTOBER 2016

**PERMANENT FILL
QUANTITIES**

CUT CY	FILL CY
-	90,000

NOTE:
PERMANENT FILL IS AN ESTIMATE
OF FILL PLACED ON SITE PER
GRADING AND DRAINAGE PLANS
PREPARED BY CARLILE MACY
DATED MAY 1998, FILE NO. B-147114,
RENEWED AS BRD02-0210,
DECEMBER 2002

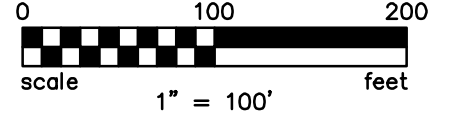

**EXISTING GRADING PLAN
PERMANENT FILL AND
AND
TEMPORARY FILL QUANTITIES
304 TODD ROAD**

APN 134-171-050
SANTA ROSA, CALIFORNIA

JANUARY 2018



CIVIL ENGINEERS • URBAN PLANNERS • LAND SURVEYORS • LANDSCAPE ARCHITECTS
15 THIRD STREET, SANTA ROSA, CA 95401
TEL (707) 542-6451 FAX (707) 542-5212

PROJECT No. 1996087.A0

SHEET 2 OF 3

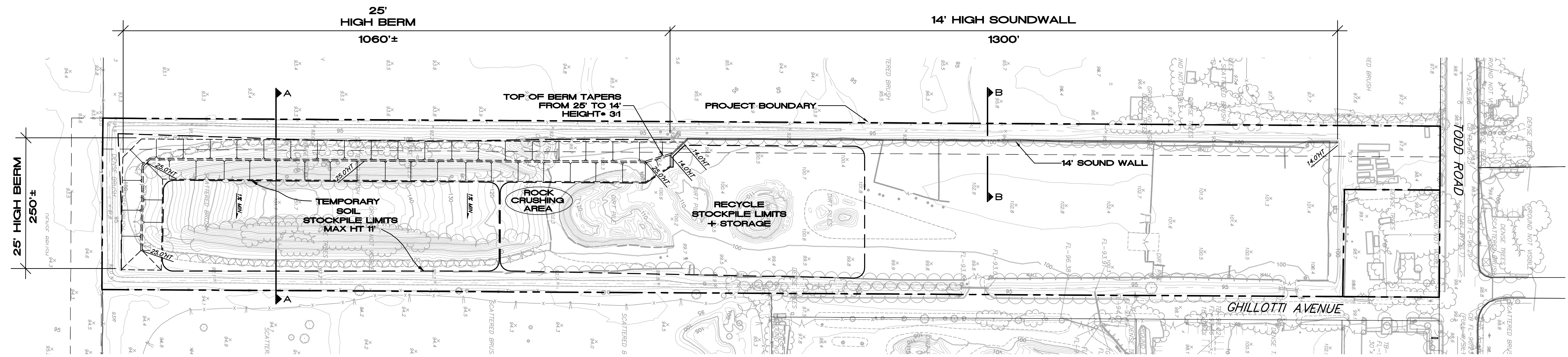

NOTE:
GRADING CONTOUR INTERVAL = 2'

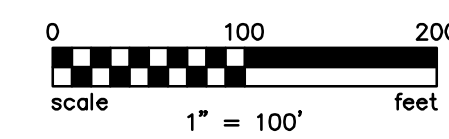
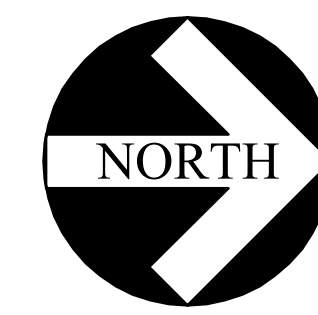
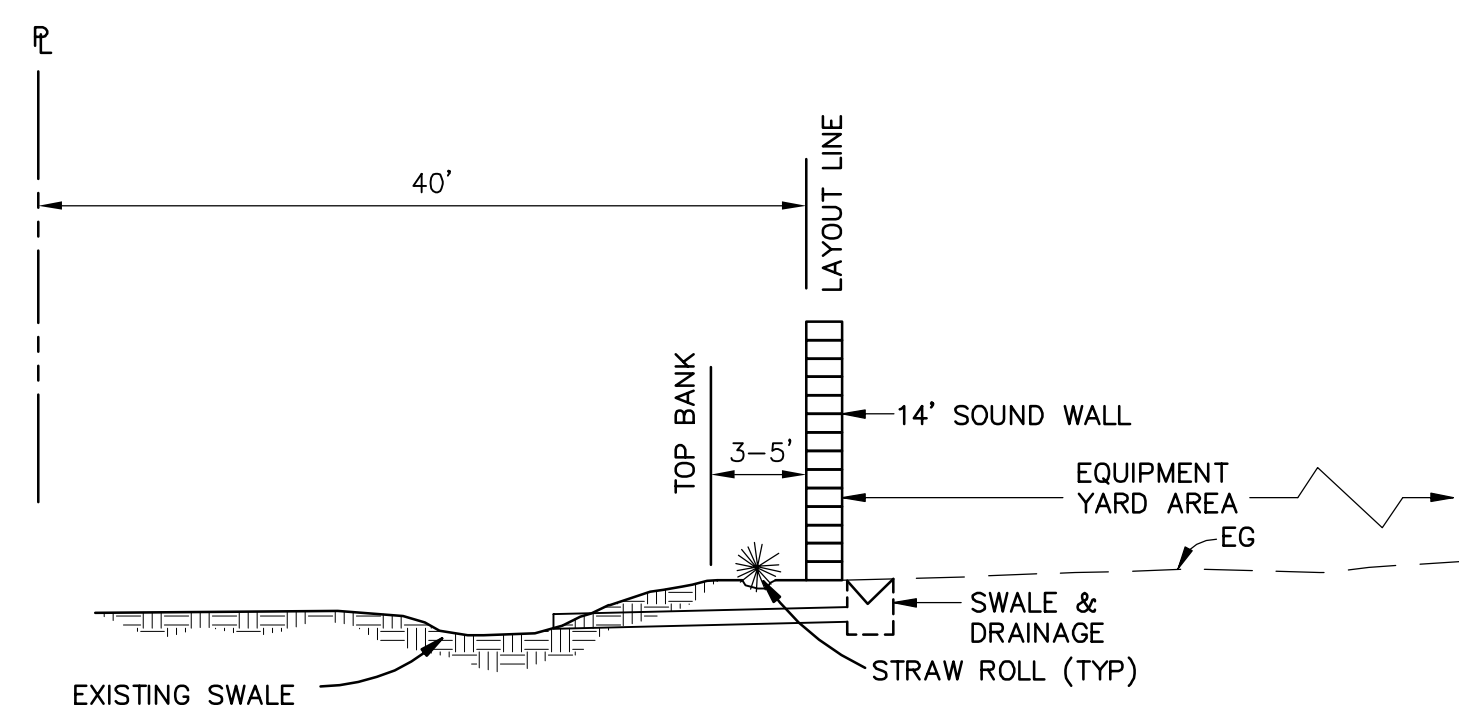
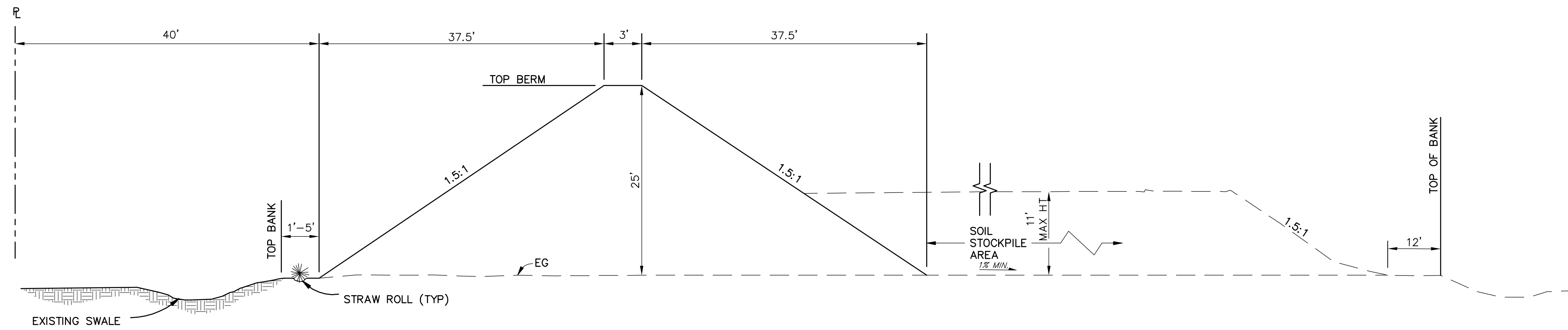

PROPOSED GRADING + STOCKPILE PLAN

304 TODD ROAD

APN 134-171-050
SANTA ROSA, CALIFORNIA
JANUARY 2018



CIVIL ENGINEERS • URBAN PLANNERS • LAND SURVEYORS • LANDSCAPE ARCHITECTS

15 THIRD STREET, SANTA ROSA, CA 95401
TEL (707) 542-6451 FAX (707) 542-5212

PROJECT No. 1996087.A0

SHEET 3 OF 3