

FOR REDUCED PLANS, THE ORIGINAL SCALE IS IN INCHES

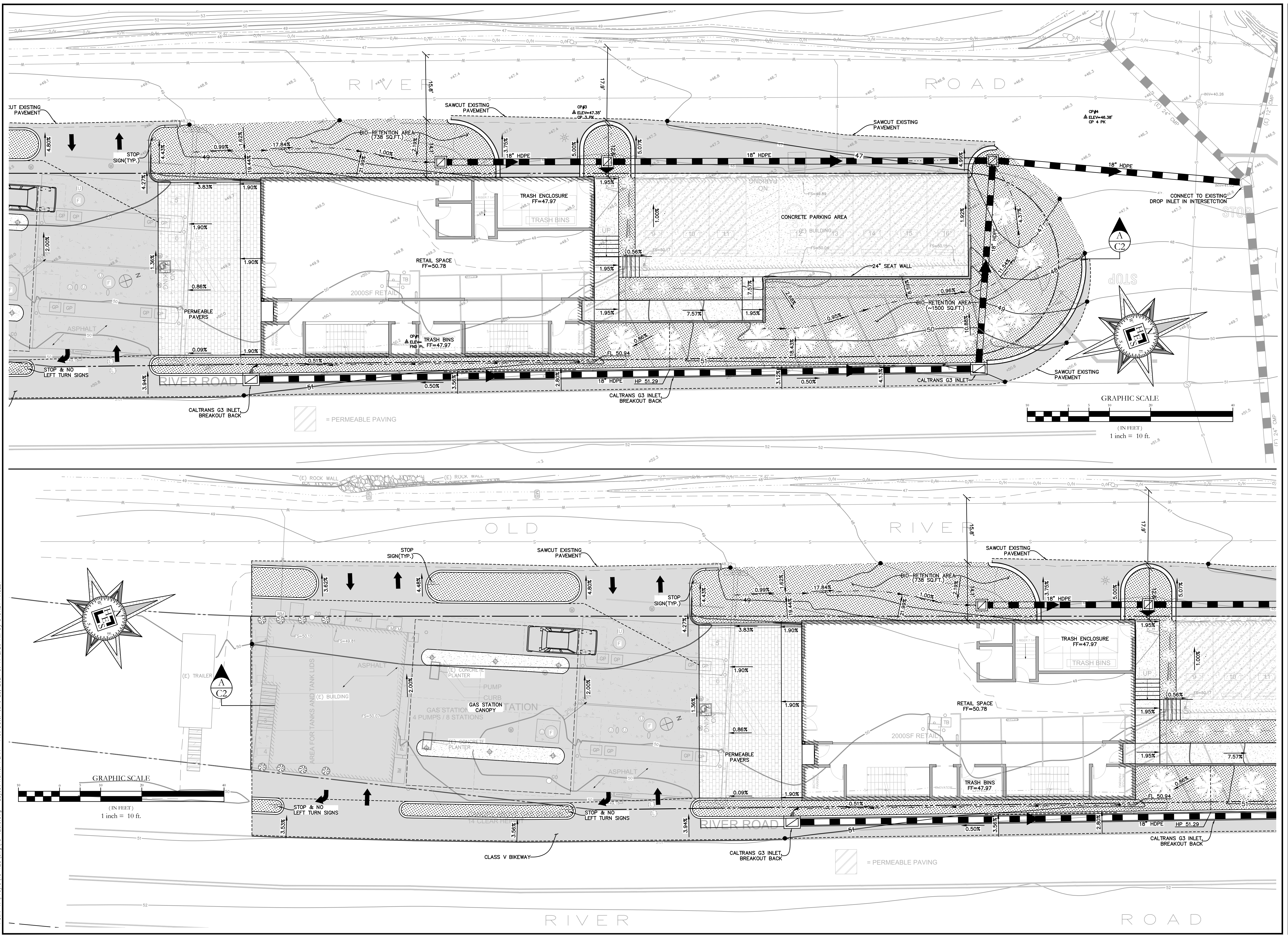

**Huffman Engineering & Surveying**  
 537 College Avenue, Suite A  
 Santa Rosa, Ca. 95404  
 P:(707) 542-6559  
 www.huffmanengineering.net

#	Date	Description

Engineers:

Rob Huffman P.E. 42293

**Lands of Dhillon**  
 Preliminary Civil Grading Plan  
 15190 River Road  
 Guerneville  
 A.P.N.:070-130-033

Date: 01/31/20 Scale: 1" = 10'  
 File: 18-128.3 Sheet  
 Drawn: SMA **C1**  
 Job: 18-128 Of 2 Sheets

FOR REDUCED PLANS, THE ORIGINAL SCALE IS IN INCHES

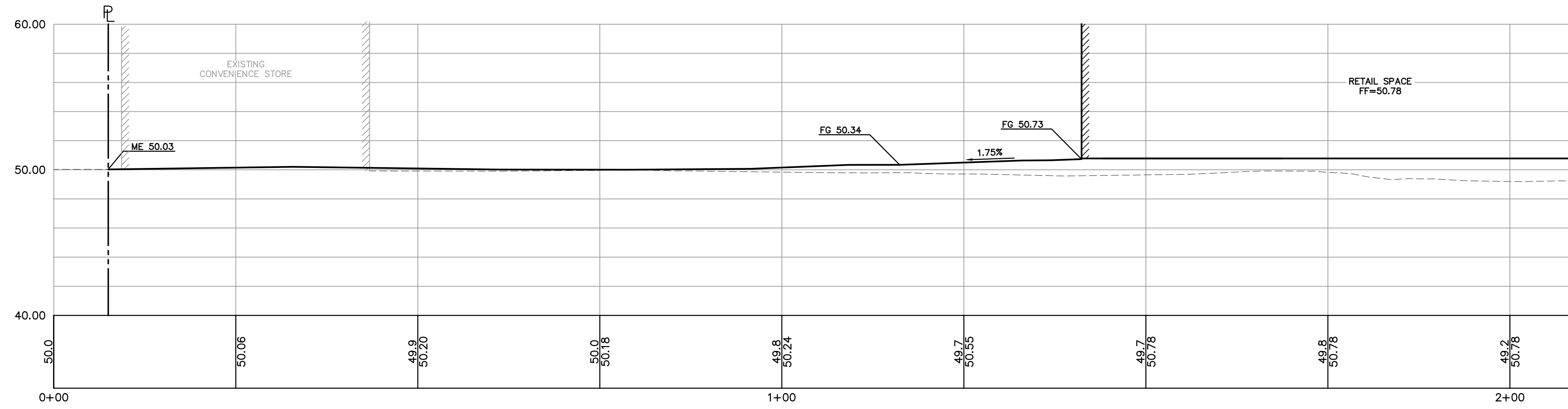

**Section A-A**  
SCALE: H:1"=10' V:1"=5'

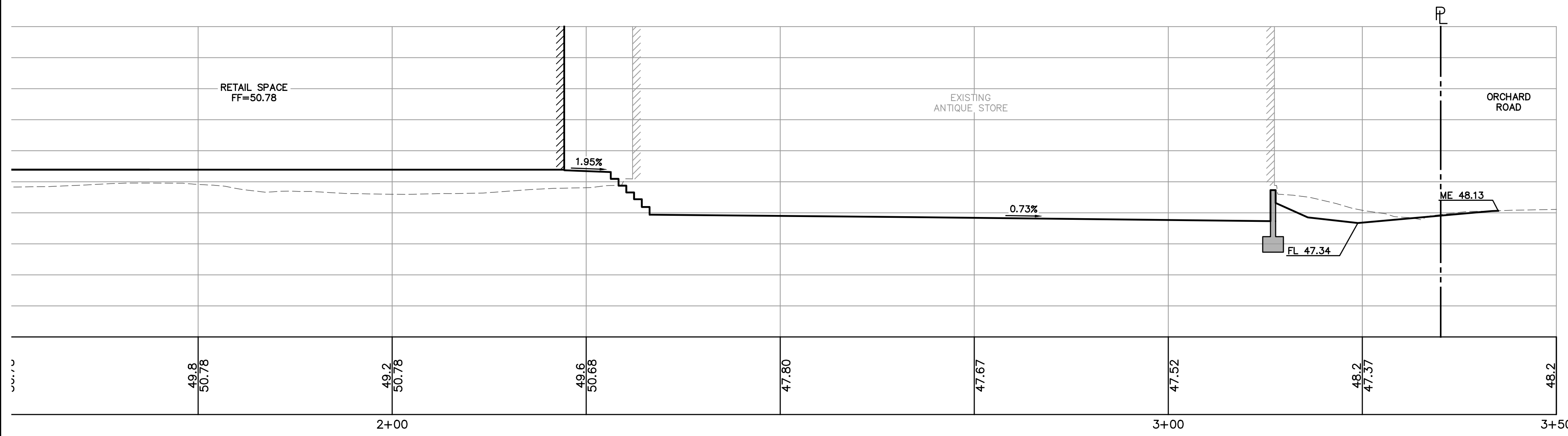

**Section A-A**  
SCALE: H:1"=10' V:1"=5'

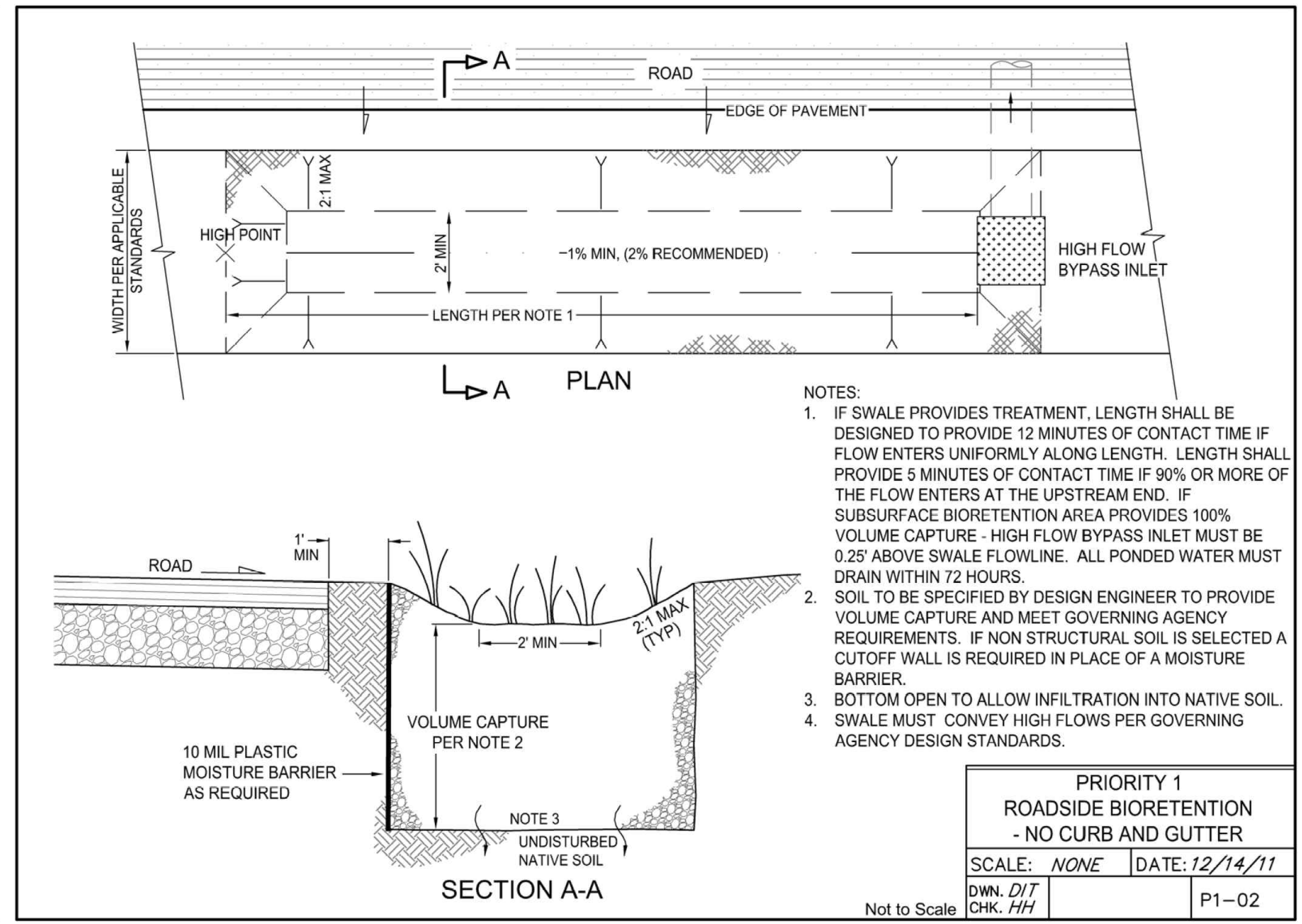
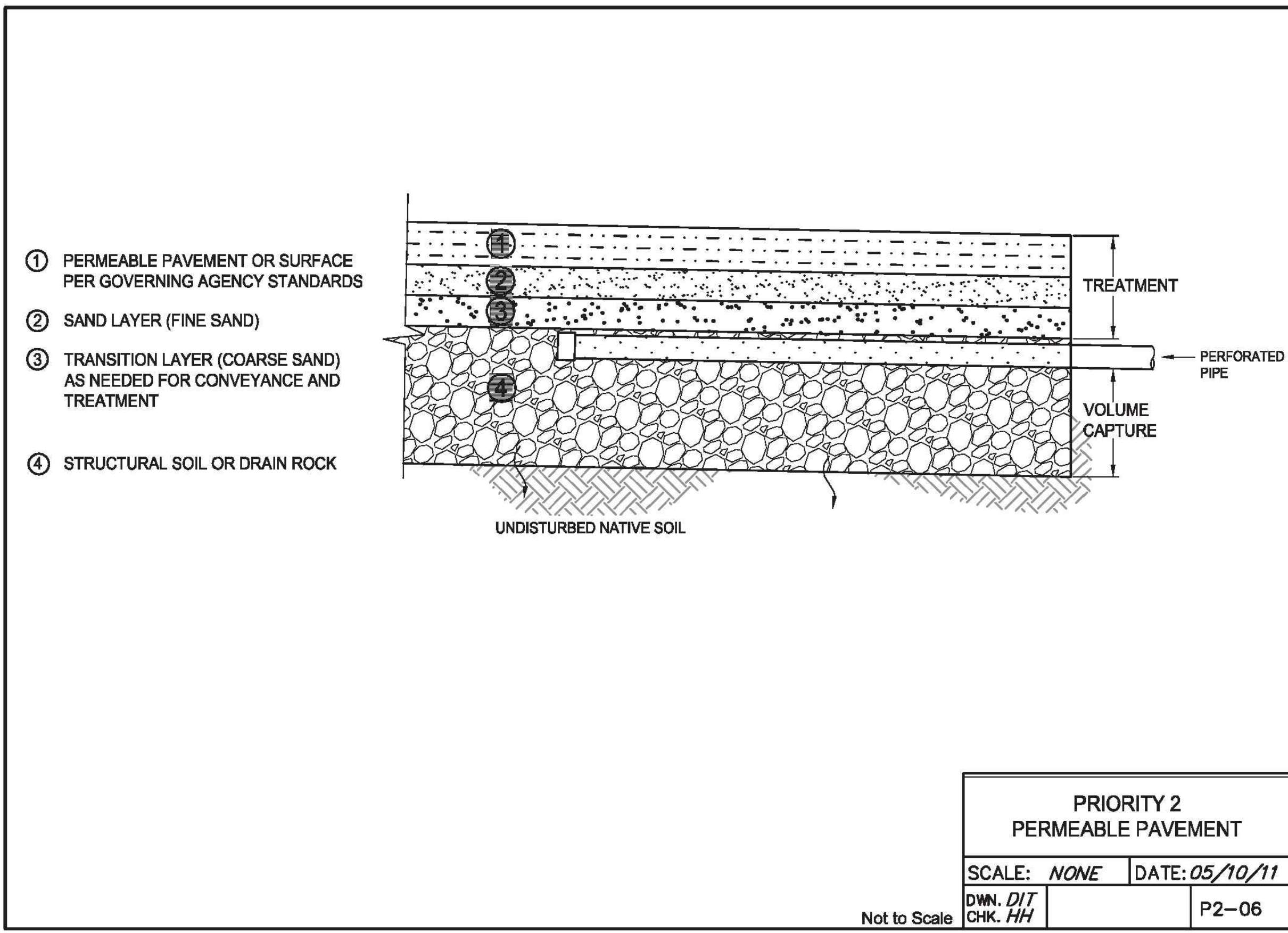

- NOTES:
- IF SWALE PROVIDES TREATMENT, LENGTH SHALL BE DESIGNED TO PROVIDE 12 MINUTES OF CONTACT TIME IF FLOW ENTERS UNIFORMLY ALONG LENGTH. LENGTH SHALL PROVIDE 5 MINUTES OF CONTACT TIME IF 90% OR MORE OF THE FLOW ENTERS AT THE UPSTREAM END. IF SUBSURFACE BIORETENTION AREA PROVIDES 100% VOLUME CAPTURE - HIGH FLOW BYPASS INLET MUST BE 0.25' ABOVE SWALE FLOWLINE. ALL PONDED WATER MUST DRAIN WITHIN 72 HOURS.
  - SOIL TO BE SPECIFIED BY DESIGN ENGINEER TO PROVIDE VOLUME CAPTURE AND MEET GOVERNING AGENCY REQUIREMENTS. IF NON STRUCTURAL SOIL IS SELECTED A CUTOFF WALL IS REQUIRED IN PLACE OF A MOISTURE BARRIER.
  - BOTTOM OPEN TO ALLOW INFILTRATION INTO NATIVE SOIL.
  - SWALE MUST CONVEY HIGH FLOWS PER GOVERNING AGENCY DESIGN STANDARDS.

**Huffman Engineering & Surveying**  
537 College Avenue, Suite A  
Santa Rosa, Ca. 95404  
P:(707) 542-6559  
www.huffmanengineering.net

#	Date	Description

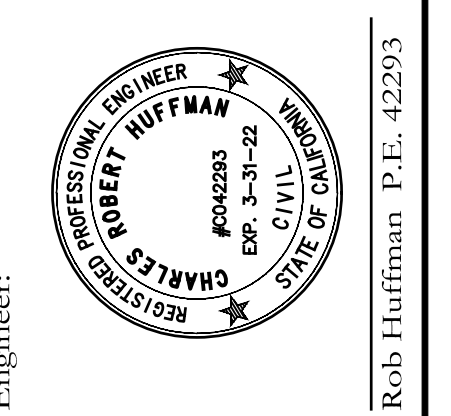

**Lands of Dhillon**  
Cross Sections & Details  
15190 River Road  
Guerneville  
A.P.N.:070-130-033